

- PENDANTS: seven
- CANOPY: brushed-nickel canopy 203mm (8") in diameter and 32mm (1.3") deep
- LAMPING: 10w xenon or 1.8w LED
- LENGTH OF COAX: 3000 (10') standard / 30500 (100') maximum
- INSTALLATION: strain relief (pendant light site adjustable)
- MATERIALS: Cast glass, blown borosilicate glass, braided metal coaxial cable, electrical components brushed nickel canopy
- WEIGHT: approximately 14kg (30lb)
- TRANSFORMERS: integral

DESCRIPTION

14.7 is a random configuration of seven 14 pendants hung from a round canopy. The pendants are designed to hang in a random configuration at times clustering and grouping together and others trailing off. The result is an ambient chandelier or field of light. The pendant drop lengths on this chandelier are adjustable up to the specified maximum.

The 14 is an articulated, seamed cast glass sphere with a frosted cylindrical void that houses a low voltage lamp. Individual pendants are visually quite subtle, but gain tremendous strength when multiplied and clustered in large groups.

NOTES

- + Purchase replacement lamps online at www.bocci.ca/lamps
- + Unless otherwise noted when ordering, all chandeliers will be outfitted to be xenon compatible.
- + Note: As an alternative to a built-in transformer, Bocci recommends mounting transformers remotely in an easily accessible and hidden location for ease of long-term maintenance.

US patent # D556, 361 Worldwide patents issued and pending.
Made in Vancouver, Canada

approx 14kg (30lb)

BOCCI Vancouver
sales@bocci.ca
www.bocci.ca

BOCCI Berlin
europe@bocci.ca
www.bocci.ca

14.7 Design by Omer Arbel
PRODUCT SPECIFICATION

Approved to UL standards by CSA



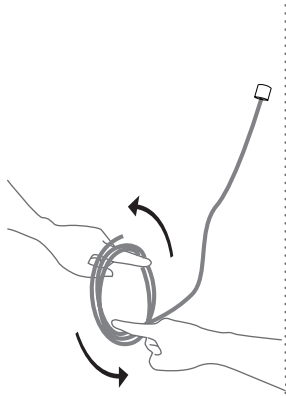

1

Very carefully uncoil the braided coaxial cable in a spool like manner. Insert your index fingers into opposite sides of the roll then rotate your fingers around each other to unroll the coaxial cable. Use patience: allow the cable to uncoil completely to avoid kinks.

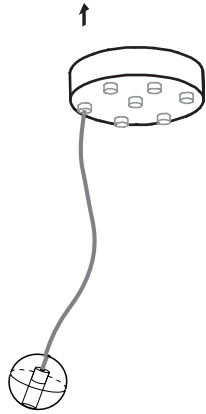

2

Thread the coaxial cable through the canopy. Throughout installation be mindful not to damage the borosilicate tube inside the pendant.

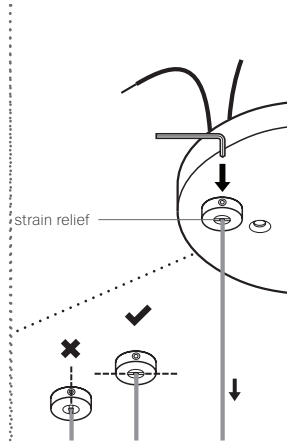

3

Determine the overall drop for the pendant fixture. Use the Allen key provided to loosen the setscrew in the canopy and gently feed the cable through the canopy until you have reached your desired drop length. Use Allen key to tighten the setscrew hold the strain relief to secure the coaxial cable at its new length. **DO NOT OVERTIGHTEN.**

Note: The strain relief is a black plastic collar around the coaxial cable. There is a single slot opening on the side of the strain relief component. It is essential that this opening is oriented at 90 degrees to set screw chamber. There can be no contact between the set screw and the cable.
- RISK OF ELECTRIC SHORT!

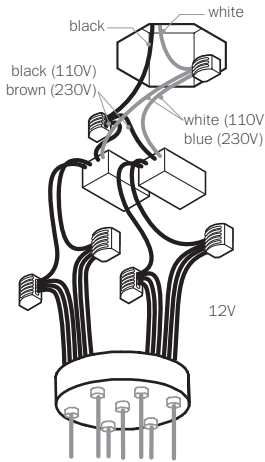

4

Xenon/Halogen/LED: Connect the coaxial cable to the open slots in the terminal block on the 12V side of the transformers. Ensure that the braided outer wires are all connected to one 12V output wire and all inner insulated wires are connected to the other or a short will occur.

Once all the coaxial connections are made, lift the fixture into position and connect the line voltage to the open slot in the appropriate terminal block.

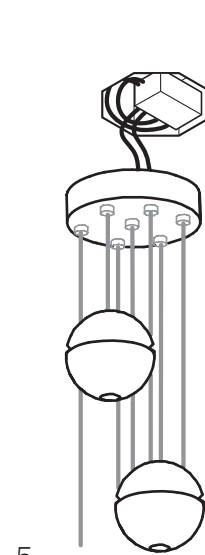

5

Tuck the transformers and wiring into the octagonal box, if available, and place canopy cover plate, lining up the fastener holes or connect directly to structural ceiling surface. Affix canopy cover with fasteners provided.

Note: It may be helpful to rest the pendants on a surface higher than its final position so that the canopy may be fastened with greater ease.

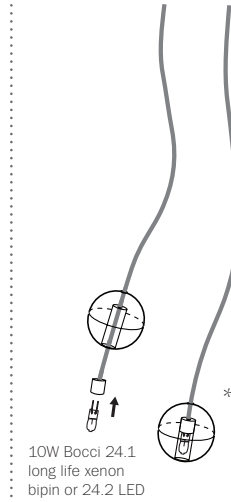

6

Bocci 24.1 long life bipin xenon lamps included. Bocci 24.2 LED lamps optional. Lamping is transformer specific.

Plug the lamp into the socket. Do not touch the lamp with your bare hands.

Purchase replacement lamps online at www.bocci.ca/lamps

Note: when using a dimmer for xenon, use only low voltage electronic dimmer to ensure the fixture works properly.

*** WET LOCATION INFO**

If the wet location option is chosen, lower the top silicon seal, ensuring that it is firmly inserted into the pendant opening and that the flattened collar makes contact with the pendant.

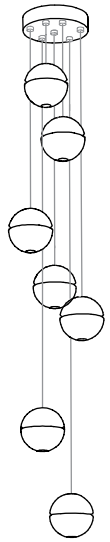

7

Clean fingerprints from glass surfaces.

Turn fixture on.

*

For additional assistance, please contact Bocci:

BOCCI Vancouver
info@bocci.ca
www.bocci.ca

BOCCI Berlin
europe@bocci.ca
www.bocci.ca

Worldwide patents issued and pending.

US patent # US D556,361

Made in Vancouver, Canada

Approved to UL standards by CSA

